

Unmanaged 4*1000Base T(X)+ 2*1000Base SFP FX Industrial Ethernet Switch Dinrail Switch

Unmanaged Industrial Ethernet Switch

P/N : ITT-SW1735



Ittelecom unmanaged MIB12G-4EG-2G-E provides 2*1000Base SFP TX/FX ports and 4*1000BaseT(X) Ethernet ports. No fan, low power consumption design; Din rail corrugated metal casing, meet IP40 protection grade; Dual redundant power input; Comply with CE, FCC and ROHS standards. This series' wide operating temperature range and port surge protection design are ideal for application in large flow real-time outdoor environment, and are widely used in industrial automation control and surveillance occasions like campus, community, rail traffic, electric

- 4*1000Base T(X) fast Ethernet ports & 2*1000Base SFP FX fiber optic ports
- IEEE802.3/802.3u//802.3x, store and forward
- Wire speed forwarding capability of all ports make sure of non-blocking message forwarding.
- Automatic MDI/MDI-X crossover for plug-and-play
- Dual redundant power input, with overload protection and power reverse polarity protection.
- Support full-loaded operating temperature range -40 to 85°C.
- No fan, low power consumption design.
- Din rail corrugated metal casing, meet IP40 protection grade.
- Industrial Level-4 design.
- IP40 protection level.

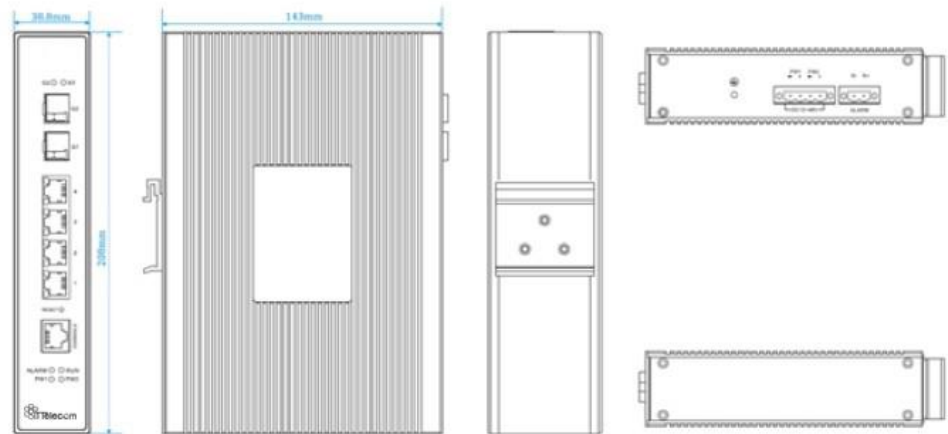

SERVICES:
Guaranteed Warranty



Unmanaged 4*1000Base T(X)+ 2*1000Base SFP FX Industrial Ethernet Switch Dinrail Switch



Specification

Standards:	IEEE 802.3,802.3u,802.3x, 802.3ab, 802.3z
Certifications	CCC, CE, FCC, RoHS
Gigabit Ethernet port	10/100/1000 Base-T(X) auto-adaptive RJ45
Gigabit Fiber port	1000Base-SFP FX port
Power port	5.08mm industrial terminal
Processing Type	Store & forward, wire speed switching
Switching bandwidth	50Gbps
Packet forwarding speed	37.2Mpps
MAC Address	8K
Buffer Memory	512KB
Input Voltage Range	12-24VDC redundant input
Idle Consumption	0.33A@12VDC(Max)
Full -load Consumption	0.57A@12VDC(Max)
Connection	5.08mm industrial terminal
Protection	Overload Current Protection; Redundancy protection
Casing	Strengthened corrugated metal casing
Protection grade	IP40
Dimension(L*W*H)	208*143*38.8mm
Installation	Din Rail
Weight	1058g
Operating Temperature	-40°C~+85°C
Storage Temperature	-45°C~+85°C
Relative Humidity	5~95%,non-condensing
EMI	FCC Part 15,CISPR(EN55022) class A
EMS	EN61000-4-2(ESD), Level 4
	EN61000-4-3(RS),Level 3
	EN61000-4-4(EFT),Level 4
	EN61000-4-5(Surge),Level 4
	EN61000-4-6(CS),Level 3
	EN61000-4-8,Level 5
Shock	IEC 60068-2-27
Free Fall	IEC 60068-2-32
Vibration	IEC 60068-2-6

SERVICES:
Guaranteed Warranty



Website: ittelecom.co
Skype: [ittelecomco](https://www.skype.com/en/contacts/ittelecomco)
Email: mailto:sale@ittelecom.co

Unmanaged 4*1000Base T(X)+ 2*1000Base SFP FX Industrial Ethernet Switch Dinrail Switch

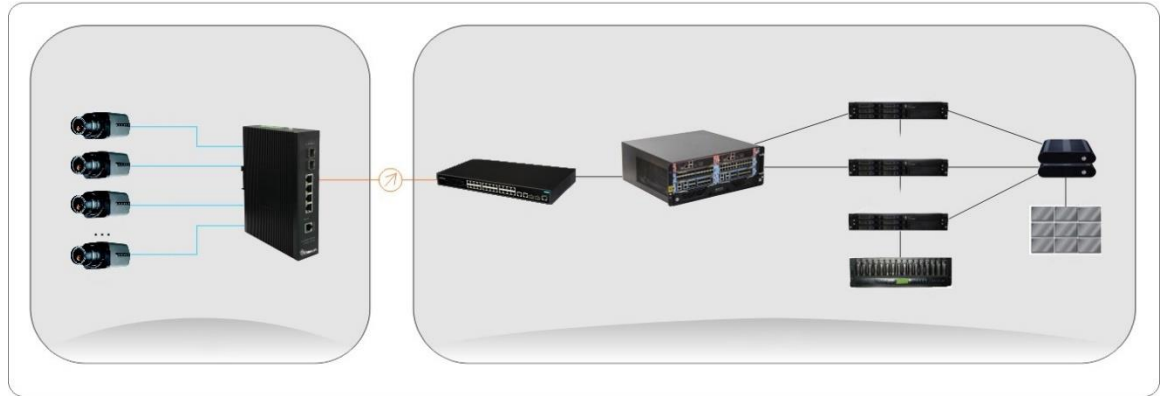

Ordering Information

Port Interface 1000Base TX/FX SFP	2
Port Interface 10/100/1000Base T(X)	4

SERVICES:
Guaranteed Warranty

