



### Features:

- -40 to 85°C operating temperature range
- IP40 protection class with metal housing
- Fanless design
- Level 4 EMC Protection
- PoE, IEEE802.3af/at
- One key ring configuration
- ERPS with protection switching time < 20ms
- WEB, Telnet, CONSOLE, EMS management

### Overview:

ITT-ISWP-L2-8G2S is a managed L2 industrial Ethernet switch providing 8 electrical and 2 optical gigabit Ethernet ports. The 8 electrical ports support POE and provide maximum 30W/port output. It supports abundant L2 features such as VLAN, STP/RSTP/MSTP, ERPS, QoS, ACL, and supports Web/CLI management and third-party SNMP management. All models are with IP40 protection class and meet EMC industrial level 4 requirements. The product supports wide power input voltage range of 36-56VDC and wide operating temperature range of -40 to the +85°C. In addition to its compact size for space-saving installation, each product has passed a 100% burn-in test in 85°C to ensure its quality high-reliability transmission.

All of these features make the product ideal for applications that require high-reliability transmission, such as video surveillance, tolling systems, ITS, and factory automation.

### Technical Parameters:

• <b>Standard</b>	<ul style="list-style-type: none"> <li>➢ IEEE 802.3 10Base-T</li> <li>➢ IEEE 802.3u 100Base-Tx</li> <li>➢ IEEE 802.3ab 1000Base-T</li> <li>➢ IEEE 802.3z 1000Base-X</li> </ul>
• <b>Interface</b>	<ul style="list-style-type: none"> <li>➢ Console Ports: 1 RS-232(RJ45)</li> <li>➢ Optical Ports: 2 1000Base-X (SFP)</li> <li>➢ Electrical Ports: 8 10/100/1000/Base-T (RJ45)</li> </ul>
• <b>LED indicator</b>	<ul style="list-style-type: none"> <li>➢ Power LED: PWR</li> <li>➢ Interface LED: RJ45(Link&amp;ACT), Fiber(Link&amp;ACT)</li> </ul>
• <b>PoE Function</b>	<ul style="list-style-type: none"> <li>➢ IEEE 802.3.af : 15.4W per port      IEEE 802.3bt : 55W per port</li> <li>➢ IEEE 802.3.at : 35W per port</li> </ul>
• <b>Power</b>	<ul style="list-style-type: none"> <li>➢ Power Terminal: 5-pin 5.08mm-spacing plug-in terminal block</li> <li>➢ Full load power consumption: &lt; 13W , POE:&lt;300W</li> <li>➢ Overload Protection: Support</li> <li>➢ Reverse Connection Protection: Support</li> <li>➢ Redundancy Protection: Support</li> </ul>

<ul style="list-style-type: none"> <li>• <b>Physical Characteristics</b></li> </ul>	<ul style="list-style-type: none"> <li>➤ Housing: Metal, fanless</li> <li>➤ Protection Class: IP40</li> <li>➤ Dimensions : 45mm x 179mm x 100mm(W×H×D)</li> <li>➤ Weight: 0.80kg</li> <li>➤ Mounting: DIN-Rail or Panel mounting</li> </ul>
<ul style="list-style-type: none"> <li>• <b>Switch Properties</b></li> </ul>	<ul style="list-style-type: none"> <li>➤ MAC Table: 8K</li> <li>➤ Packet buffer: 4M</li> <li>➤ VLAN: 4K</li> <li>➤ VLAN Mode: Access/Trunk/Hybrid</li> <li>➤ 802.1Q/port/protocol/MAC/IP subnet based VLAN;</li> <li>➤ QinQ and VLAN translation;</li> <li>➤ IGMP snooping v1/v2/v3, IGMP proxy, MVR;</li> <li>➤ DHCP client/sever/relay</li> <li>➤ LACP for port bandwidth extension, load balance;</li> <li>➤ STP/RSTP/MSTP for ring protection;</li> <li>➤ ERPS with protection switching time &lt;20ms;</li> <li>➤ one key ring configuration for STP/RSTP/ERPS;</li> <li>➤ Loopback detection and loopback test;</li> <li>➤ 8-queue QoS with SP/WRR scheduling policy;</li> <li>➤ Rate limitation and traffic shapping;</li> <li>➤ DLF/multicast/broadcast limitation;</li> <li>➤ MAC/VLAN/IP/TCP/UDP port/ToS based ACL</li> <li>➤ Dynamic MAC learning and static MAC configuration;</li> <li>➤ MAC addresss learning enable/disable per port;</li> <li>➤ MAC limitation per port;</li> <li>➤ Fiber RDI Remote Defect Indication) alarm;</li> <li>➤ Dying Gasp remote equipment fail alarm;</li> <li>➤ 801.2x, RADIUS, TACACS+</li> <li>➤ HTTPS, SSH;</li> <li>➤ Port mirror;</li> <li>➤ RMON group 1, 2, 3, 9;</li> <li>➤ SNMP v1/v2c/v3;</li> <li>➤ Online upgrade and dual-Image firmware;</li> <li>➤ Configuration backup and restore;</li> <li>➤ CONSOLE and telnet for CLI management;</li> <li>➤ WEB management;</li> </ul>
<ul style="list-style-type: none"> <li>• <b>Industrial Standard</b></li> </ul>	<ul style="list-style-type: none"> <li>➤ EMI: FCC CFR47 Part 15, EN55022/CISPR22, Class A</li> <li>➤ EMS: <ul style="list-style-type: none"> <li>IEC61000-4-2 (ESD): ±8kV (contact), ±15kV (air)</li> <li>IEC61000-4-3 (RS): 10V/m (80MHz-2GHz)</li> <li>IEC61000-4-4 (EFT): Power Port: ±4kV; Data Port: ±2kV</li> <li>IEC61000-4-5 (Surge): Power Port: ±2kV/DM, ±4kV/CM; Data Port: ±2kV</li> <li>IEC61000-4-6 (CS): 3V (10kHz-150kHz); 10V (150kHz-80MHz)</li> <li>IEC61000-4-16 (Common mode conduction): 30V (cont.), 300V (1s)</li> </ul> </li> <li>➤ Machinery: <ul style="list-style-type: none"> <li>IEC60068-2-6 (Vibration)</li> <li>IEC60068-2-27 (Shock)</li> <li>IEC60068-2-32 (Free Fall)</li> </ul> </li> </ul>
<ul style="list-style-type: none"> <li>• <b>Approvals</b></li> </ul>	<ul style="list-style-type: none"> <li>➤ CE, FCC, RoHS</li> </ul>
<ul style="list-style-type: none"> <li>• <b>MTBF</b></li> </ul>	<ul style="list-style-type: none"> <li>➤ 360,000 hrs</li> </ul>
<ul style="list-style-type: none"> <li>• <b>Environmental Limits</b></li> </ul>	<ul style="list-style-type: none"> <li>➤ Operating Temperature: -40 to 85°C</li> <li>➤ Storage Temperature: -45 to 85°C</li> <li>➤ Ambient Relative Humidity: 5 to 95% (non-condensing)</li> </ul>

### Power Input:

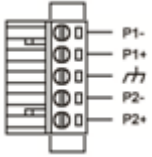

- 5-pin 5.08mm-spacing plug-in terminal
- 36-56VDC input
- P1&P2 dual power input
- Reverse protection

### Earth Protection:

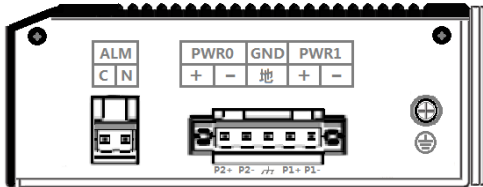

Ground terminal or screw

### Din-Rail

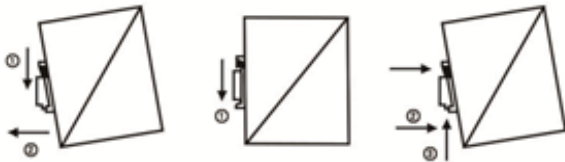

### Wall mounting

