

## Managed Layer-2 Industrial PoE Ethernet Switch 16 ETH (10/100/1000) + 4 SFP (1.25G)

P/N : [ITT-ISWP-L2-16G4S](#)



The ITT-ISWP-L2-16G4S is a managed L2 industrial Ethernet switch providing 16 electrical and 4 optical gigabit Ethernet ports. It supports abundant L2 features such as VLAN, STP/RSTP/MSTP, ERPS, QoS, ACL, and supports Web/CLI management and third-party SNMP management. All models are with IP40 protection class and meet EMC industrial level 4 requirements. It provides wide AC voltage range of 100-240V, wide operating temperature range of -40 to the + 85°C. Each product has passed a 100% burn-in test in 85°C to ensure its quality high-reliability transmission.

All of these features make the product ideal for applications that require high-reliability transmission, such as video surveillance, tolling systems, ITS, and factory automation.

- -40 to 85°C operating temperature range
- IP40 metal housing with fanless design
- Level 4 EMC Protection
- One key ring configuration
- ERPS with protection switching time < 20ms
- WEB, Telnet, CONSOLE, EMS management

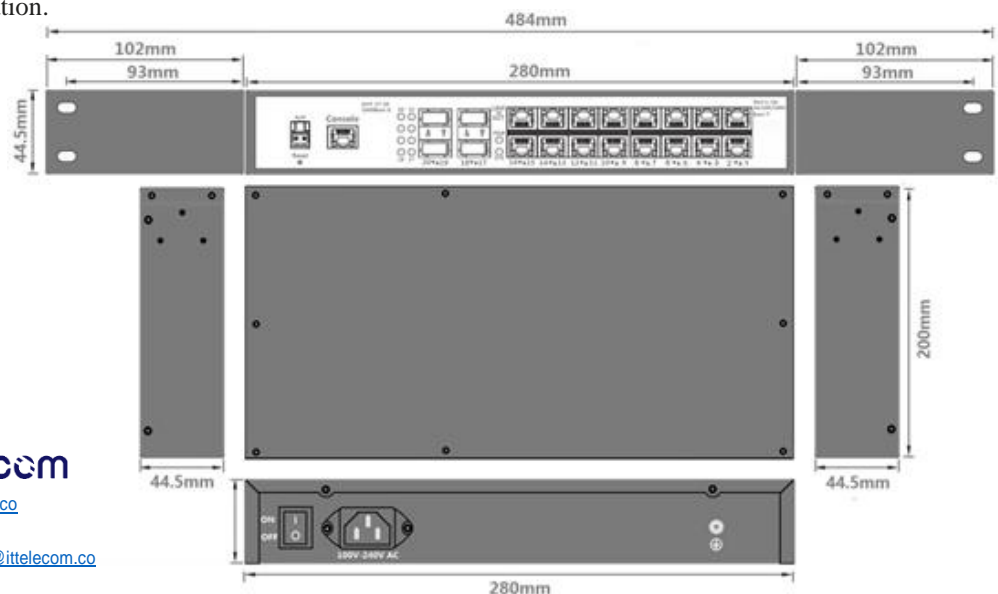

SERVICES:  
Guaranteed Warranty



Website: [ittelecom.co](http://ittelecom.co)  
 Skype: [ittelecomco](https://www.skype.com/join/ittelecomco)  
 Email: [mailto:sale@ittelecom.co](mailto:mailto:sale@ittelecom.co)

# Managed Layer-2 Industrial PoE Ethernet Switch



Network Standards	IEEE 802.3 10Base-T IEEE 802.3u 100Base-Tx IEEE 802.3ab 1000Base-T IEEE 802.3z 1000Base-X
Certifications	CCC, CE, FCC, RoHS
Switch Technical	<p>MAC Table: 8K Packet buffer: 4M VLAN: 4K VLAN Mode: Access/Trunk/Hybrid</p> <ul style="list-style-type: none"> <li>➤ 802.1Q/port/protocol/MAC/IP subnet based VLAN;</li> <li>➤ QinQ and VLAN translation;</li> <li>➤ IGMP snooping v1/v2/v3, IGMP proxy, MVR;</li> <li>➤ DHCP client/sever/relay</li> <li>➤ LACP for port bandwidth extension, load balance;</li> <li>➤ STP/RSTP/MSTP for ring protection;</li> <li>➤ ERPS with protection switching time &lt;20ms;</li> <li>➤ one key ring configuration for STP/RSTP/ERPS;</li> <li>➤ Loopback detection and loopback test;</li> <li>➤ 8-queue QoS with SP/WRR scheduling policy;</li> <li>➤ Rate limitation and traffic shapping;</li> <li>➤ DLF/multicast/broadcast limitation;</li> <li>➤ MAC/VLAN/IP/TCP/UDP port/ToS based ACL</li> <li>➤ Dynamic MAC learning and static MAC configuration;</li> <li>➤ MAC addresss learning enable/disable per port;</li> <li>➤ MAC limitation per port;</li> <li>➤ Fiber RDI Remote Defect Indication) alarm;</li> <li>➤ Dying Gasp remote equipment fail alarm;</li> <li>➤ 801.2x, RADIUS, TACACS+</li> <li>➤ HTTPS, SSH;</li> <li>➤ Port mirror;</li> <li>➤ RMON group 1, 2, 3, 9;</li> <li>➤ SNMP v1/v2c/v3;</li> <li>➤ Online upgrade and dual-Image firmware;</li> <li>➤ Configuration backup and restore;</li> <li>➤ CONSOLE and telnet for CLI management;</li> <li>➤ WEB management;</li> </ul>
Interface	<ul style="list-style-type: none"> <li>➤ Console Ports: 1 RS-232 (RJ45)</li> <li>➤ Optical Ports: 4 1000Base-X (SFP)</li> <li>➤ Electrical Ports: 16 10/100/1000Base-T (RJ45)</li> </ul>

SERVICES:  
Guaranteed Warranty



Website: [ittelecom.co](http://ittelecom.co)  
Skype: [ittelecomco](https://www.skype.com/en/contacts/ittelecomco)  
Email: [mailto:sale@ittelecom.co](mailto:mailto:sale@ittelecom.co)

LED indicator	<ul style="list-style-type: none"> <li>➤ Power LED: PWR</li> <li>➤ Interface LED: RJ45(Link&amp;ACT) , Fiber(Link&amp;ACT)</li> </ul>
MTBF	360,000 hrs
Machinery Standard	<ul style="list-style-type: none"> <li>➤ IEC60068-2-6 (Vibration)</li> <li>➤ IEC60068-2-27 (Shock)</li> <li>➤ IEC60068-2-32 (Free Fall)</li> </ul>
Power	<ul style="list-style-type: none"> <li>➤ Power Terminal: 10 A plug</li> <li>➤ Full load power consumption: &lt; 20W</li> <li>➤ Overload Protection: Support</li> <li>➤ Redundancy Protection: Support</li> </ul>
Physical	<ul style="list-style-type: none"> <li>➤ Housing: Metal, fanless</li> <li>➤ Protection Class: IP40</li> <li>➤ Dimensions : 44.5mm x 280mm x 200mm(W×H×D)</li> <li>➤ Weight: 2.5kg</li> <li>➤ Mounting: Rack mounting</li> </ul>
Environment	<ul style="list-style-type: none"> <li>➤ Operating Temperature: -40 to 85°C</li> <li>➤ Storage Temperature: -45 to 85°C</li> <li>➤ Ambient Relative Humidity: 5 to 95% (non-condensing)</li> </ul>
Industrial Standard	<ul style="list-style-type: none"> <li>➤ EMI:</li> <li>➤ FCC CFR47 Part 15, EN55022/CISPR22, Class A</li> <li>➤ EMS:</li> <li>➤ IEC61000-4-2 (ESD): ±8kV (contact), ±15kV (air)</li> <li>➤ IEC61000-4-3 (RS): 10V/m (80MHz-2GHz)</li> <li>➤ IEC61000-4-4 (EFT): Power Port: ±4kV; Data Port: ±2kV</li> <li>➤ IEC61000-4-5 (Surge): Power Port: ±2kV/DM, ±4kV/CM; Data Port: ±2kV</li> <li>➤ IEC61000-4-6 (CS): 3V (10kHz-150kHz); 10V (150kHz-80MHz)</li> <li>➤ IEC61000-4-16 (Common mode conduction): 30V (cont.), 300V (1s)</li> </ul>

SERVICES:  
Guaranteed Warranty



# Managed Layer-2 Industrial PoE Ethernet Switch

Product model	ITT-ISWP-L2-16G4S
Product descriptions	16*10/100/1000Base-T(RJ45) + 4*1000Base-X(SFP) , managed layer-2 industrial Ethernet switch , 100-240VAC

## Power Input

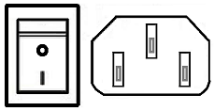

- AC-DC power module
- Input Range: 100-240VAC

## Earth Protection



Earth wire Protection

## AC Power Line

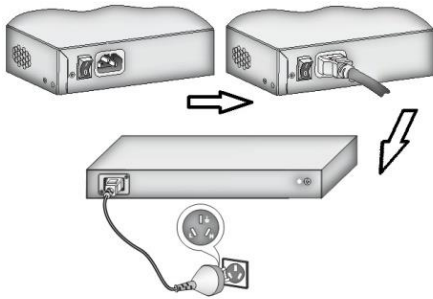

## Rack Mounting

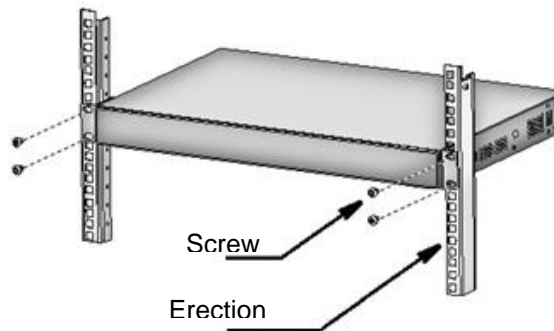

SERVICES:  
Guaranteed Warranty

