



Features:

- -40 to 85°C operating temperature range
- IP40 metal housing with fanless design
- Level 4 EMC Protection
- One key ring configuration
- ERPS with protection switching time < 20ms
- WEB, Telnet, CONSOLE, EMS management

◆ Description:

The ITT-SW4787 is a managed L2 industrial Ethernet switch providing 8 electrical and 8 optical gigabit Ethernet ports. It supports abundant L2 features such as VLAN, STP/RSTP/MSTP, ERPS, QoS, ACL, and supports Web/CLI management and third-party SNMP management. All models are with IP40 protection class and meet EMC industrial level 4 requirements. The product supports wide power input voltage range of 12-36VDC and wide operating temperature range of -40 to the +85°C. In addition to its compact size for space-saving installation, each product has passed a 100% burn-in test in 85°C to ensure its quality high-reliability transmission.

All of these features make the product ideal for applications that require high-reliability transmission, such as video surveillance, tolling systems, ITS, and factory automation.

◆ Technical Parameters:

| | |
|--|---|
| <ul style="list-style-type: none"> • Standard | <ul style="list-style-type: none"> ➤ IEEE 802.3 10Base-T IEEE 802.3u 100Base-Tx IEEE 802.3ab 1000Base-T IEEE 802.3z 1000Base-X |
| <ul style="list-style-type: none"> • Switch Properties | <ul style="list-style-type: none"> ➤ MAC Table: 8K ➤ Packet Buffer: 4M ➤ VLAN: 4K ➤ VLAN Mode: Access/Trunk/Hybrid <ul style="list-style-type: none"> • 802_1 Q/port/protocol/MAC/IP subnet based VLAN, • QinQ and VLAN translation; • IGMP snooping v1/v2/v3, IGMP proxy, MVR, • DHCP client/sever/relay • LACP for port bandwidth extension, load balance; • STP/RSTP/MSTP for ring protection; • ERPS with protection switching time <20ms; • one key ring configuration for STP/RSTP/ERPS; • Loopback detection and loopback test; • 8-queue QoS with SPWRR scheduling policy; • Rate limitation and traffic shapping; • DLF/multicast/broadcast limitation; • MAC/VLAN/IP/TCP/UDP pod/ToS based ACL • Dynamic MAC learning and static MAC configuration; • MAC addresss learning enable/disable per pott; |

| | |
|-----------------------------------|--|
| | <ul style="list-style-type: none"> • MAC limitation per port; • Fiber RDI (Remote Defect Indication) alarm; • Dying Gasp remote equipment fail alarm; _2x, RADIUS, TACACS+ • HTTPS, SSH, • Port mirror; • RMON group 1, 2, 3, g, • SNMP v1/v2c/v3, • Online upgrade and dual-Image firmware; • Configuration backup and restore; • CONSOLE and telnet for CLI management; • WEB management; |
| • Interface | <ul style="list-style-type: none"> ➤ Console Ports: 1 RS-232 (RJ45) ➤ Optical Ports: 4 1000Base-X (SFP) ➤ Electrical Ports: 16 10/100/1000/Base-T (RJ45) |
| • LED indicator | <ul style="list-style-type: none"> ➤ Power LED: PWR ➤ Interface LED: RJ45(Link&ACT) , Fiber(Link&ACT) |
| • Power | <ul style="list-style-type: none"> ➤ Power Terminal: 4-pin 5.08mm-spacing plug-in terminal block ➤ Full load power consumption: < 20W ➤ Overload Protection: Support ➤ Reverse Connection Protection: Support Redundancy Protection: Support |
| • Industrial Standard | <ul style="list-style-type: none"> ➤ EMI: ➤ FCC CFR47 Part 15, EN55022/CISPR22, Class A ➤ EMS: ➤ IEC61000-4-2 (ESD): ±8kV (contact), ±15kV (air) IEC61000-4-3 (RS): 10V/m (80MHz-2GHz) ➤ IEC61000-4-4 (EFT): Power Port: ±4kV; Data Port: ±2kV IEC61000-4-5 (Surge): Power Port: ±2kV/DM, ±4kV/CM; Data Port: ±2kV ➤ IEC61000-4-6 (CS): 3V (10kHz-150kHz); 10V (150kHz- 80MHz) ➤ IEC61000-4-16 (Common mode conduction): 30V (cont.), 300V (1s) |
| • Machinery: | <ul style="list-style-type: none"> ➤ IEC60068-2-6 (Vibration) IEC60068-2-27 (Shock) IEC60068-2-32 (Free Fall) |
| • Physical Characteristics | <ul style="list-style-type: none"> ➤ Housing: Metal, fanless ➤ Protection Class: IP40 ➤ Dimensions : 44.5mm x 199mm x 120mm(W×H×D) Weight: 0.9kg ➤ Mounting: DIN-Rail or Panel mounting |
| • MTBF | <ul style="list-style-type: none"> ➤ 360,000 hrs |
| • Environmental Limits | <ul style="list-style-type: none"> ➤ Operating Temperature: -40 to 85°C ➤ Storage Temperature: -45 to 85°C ➤ Ambient Relative Humidity: 5 to 95% (non-condensing) |
| • Approvals | <ul style="list-style-type: none"> ➤ CE, FCC, RoHS |

Installation Modes

Power Input

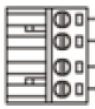

- 4-pin 5.08mm-spacing plug-in terminal
- 12V-36VDC wide voltage input
- P1&P2 dual power input
- Reverse protection

Din-Rail

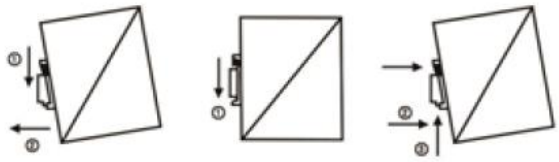

Earth Protection

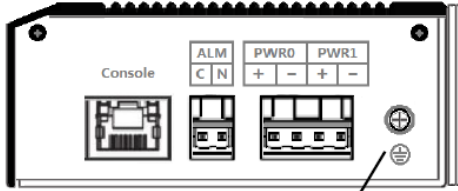

Ground Screw

Wall mounting



Mechanical Drawing

